



College Station Second Exit & Easier Access Projects

Open House

June 26, 2019

| Status of Easier Access Program

TTC's Easier Access Program will make all subway stations accessible to everyone, regardless of their level of mobility. Today, more than half of our stations are accessible to people with disabilities.

- 45 stations are now accessible.
- Stations currently under construction:
 - *Dupont, Chester, Lansdowne, Royal York, Wellesley, Yorkdale, Wilson, and Runnymede.*
- Elevator construction at Sherbourne, Bay, and Keele stations is planned to begin in late 2019.
- The remaining Stations will be made accessible by 2025.

TTC Station Location

- Existing street level exit/entrance
- Station Box
- New concourse level TTC Exit/Entrance inside the College Park building (beside the Metro)

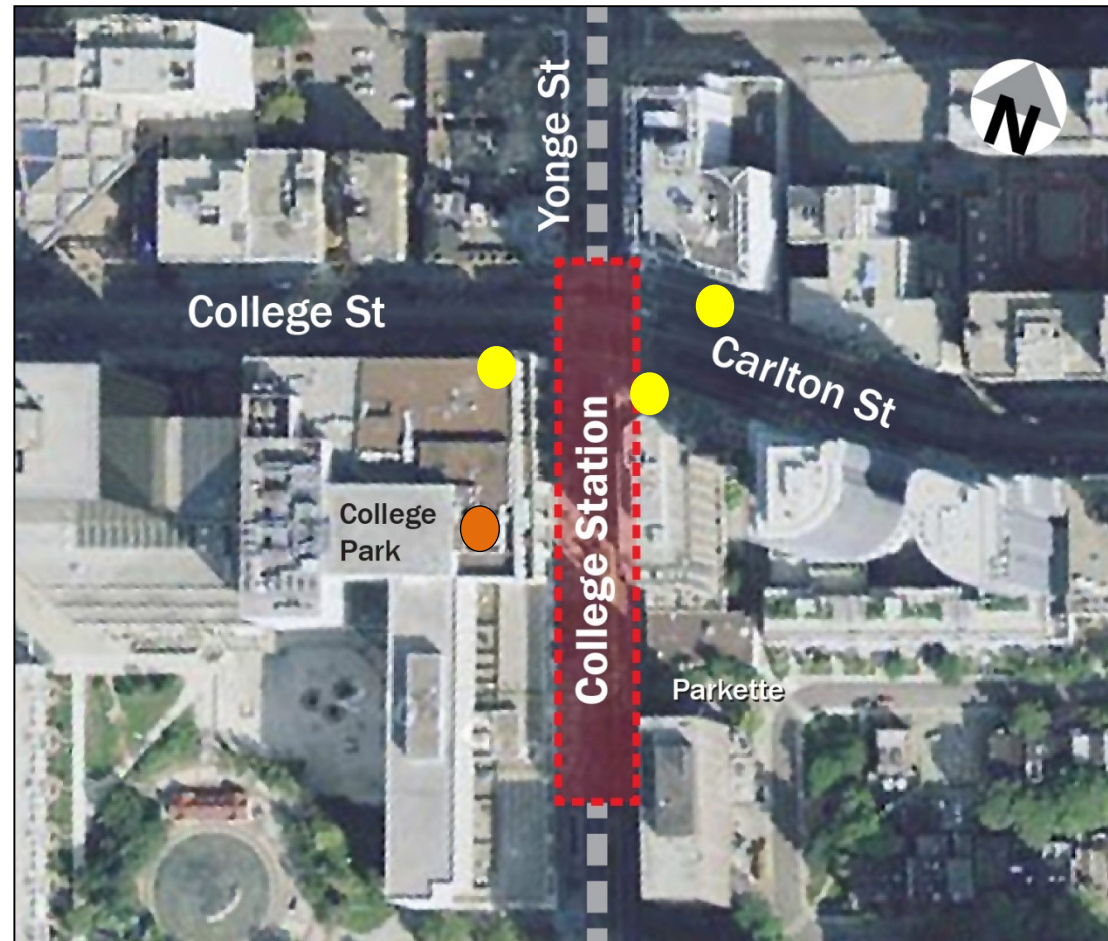

| Easier Access & Second Exit

- A new concourse to be constructed south of the existing concourse.
- The new concourse will combine new elevators and a second exit through College Park.

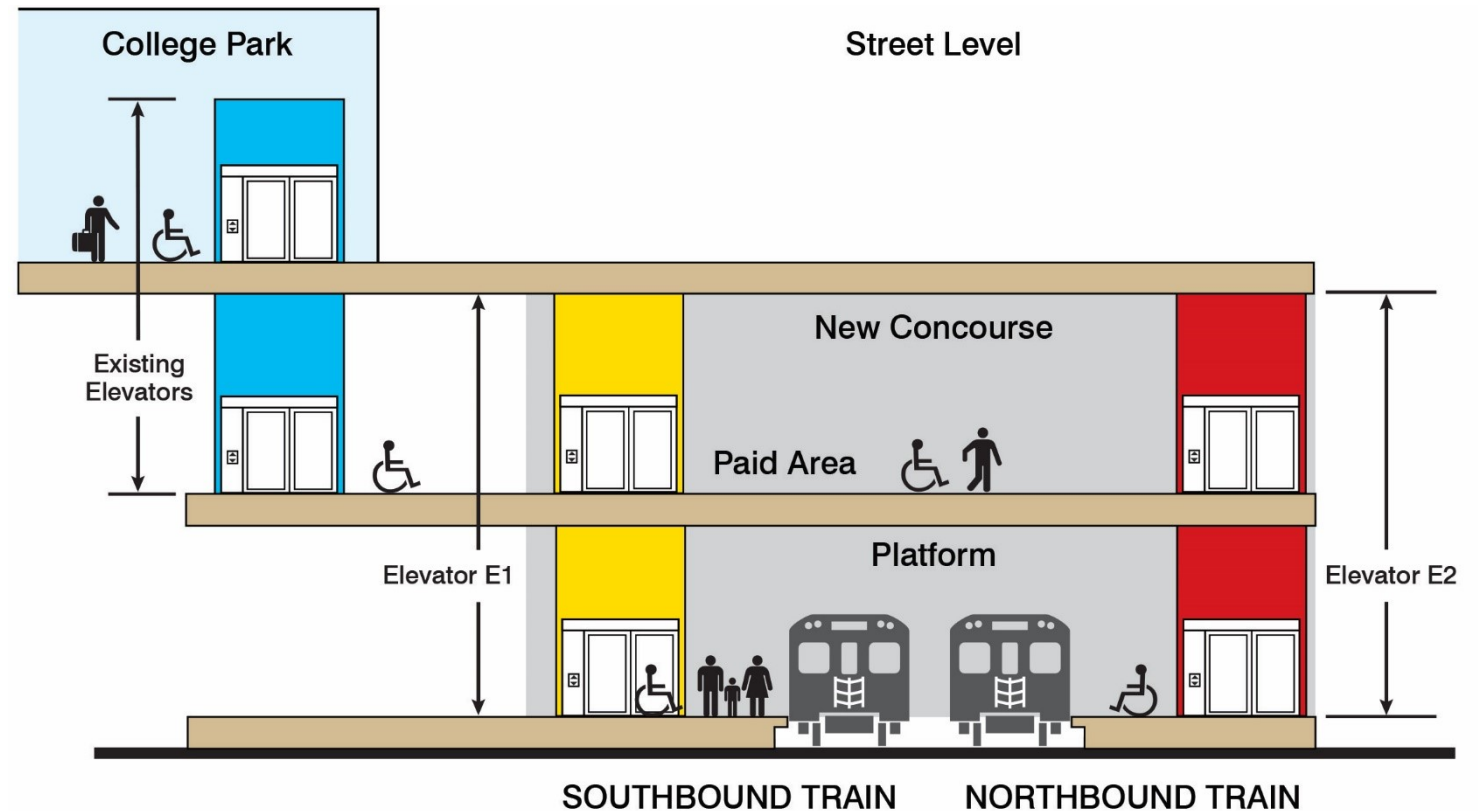

Concourse Level Rendering

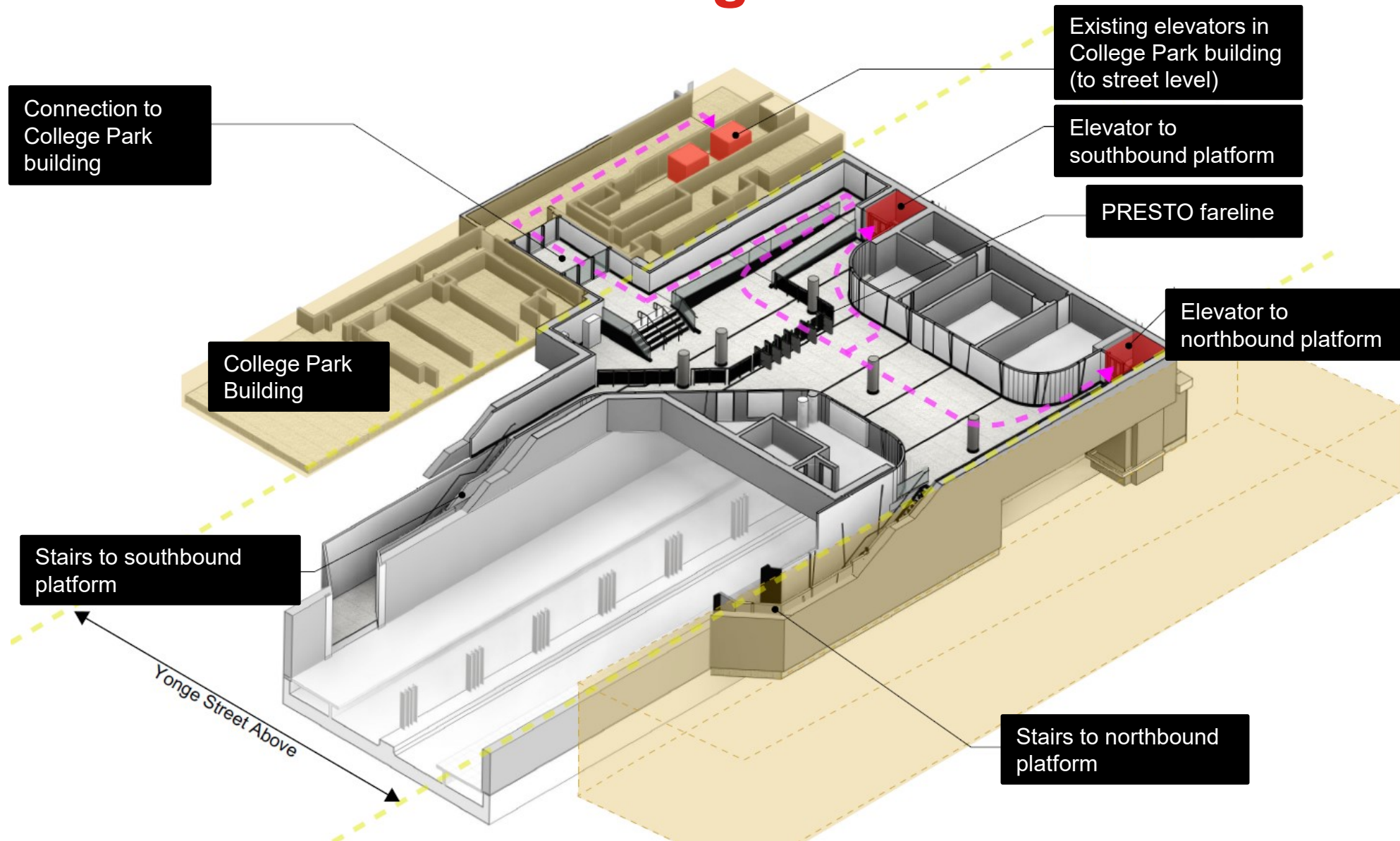

| College Station - Rendering



New concourse level

| College Station - Rendering



Easier access elevator – platform view

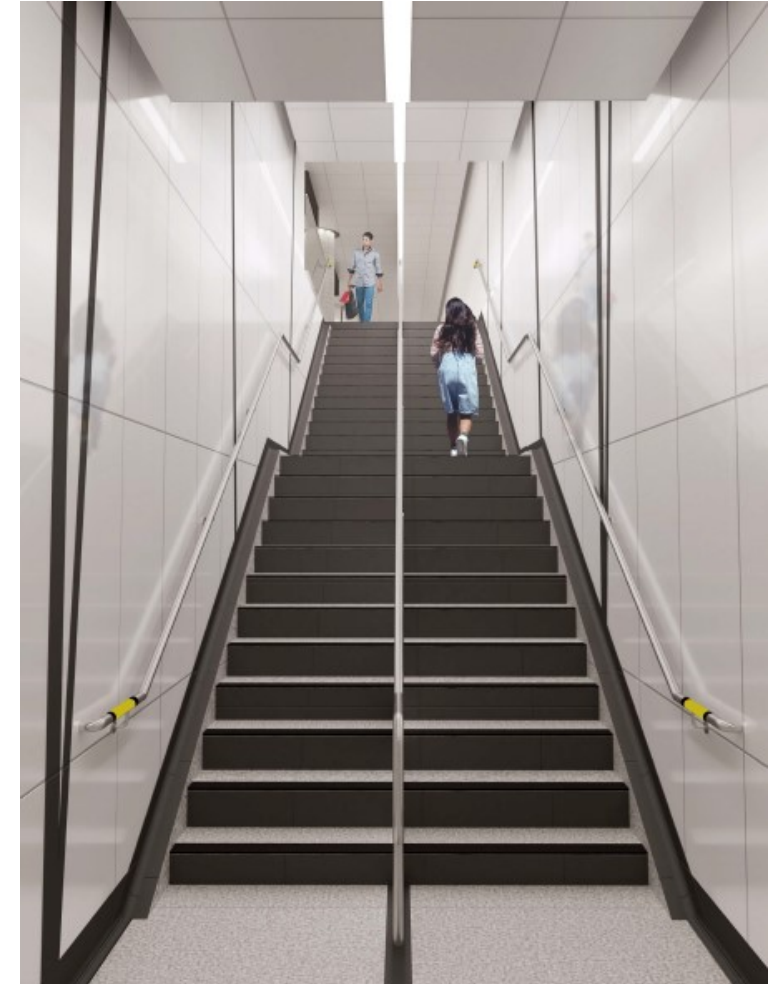

New staircase

| Construction Schedule

- Construction is expected to start in early/mid – 2020 (Quarter 2)
- Second Exit/Entrance and elevator construction is scheduled for completion in 2023

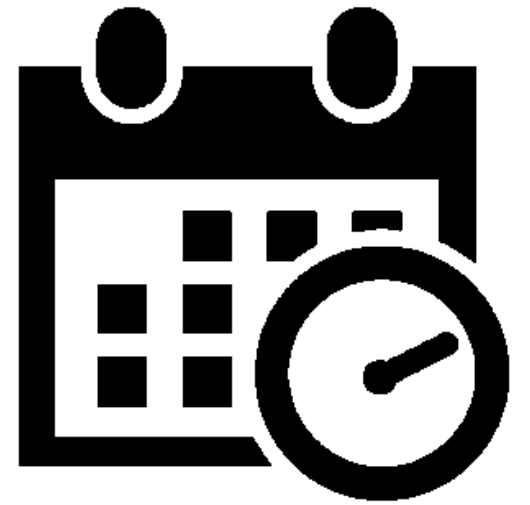

Preliminary Construction Staging – Stage 1

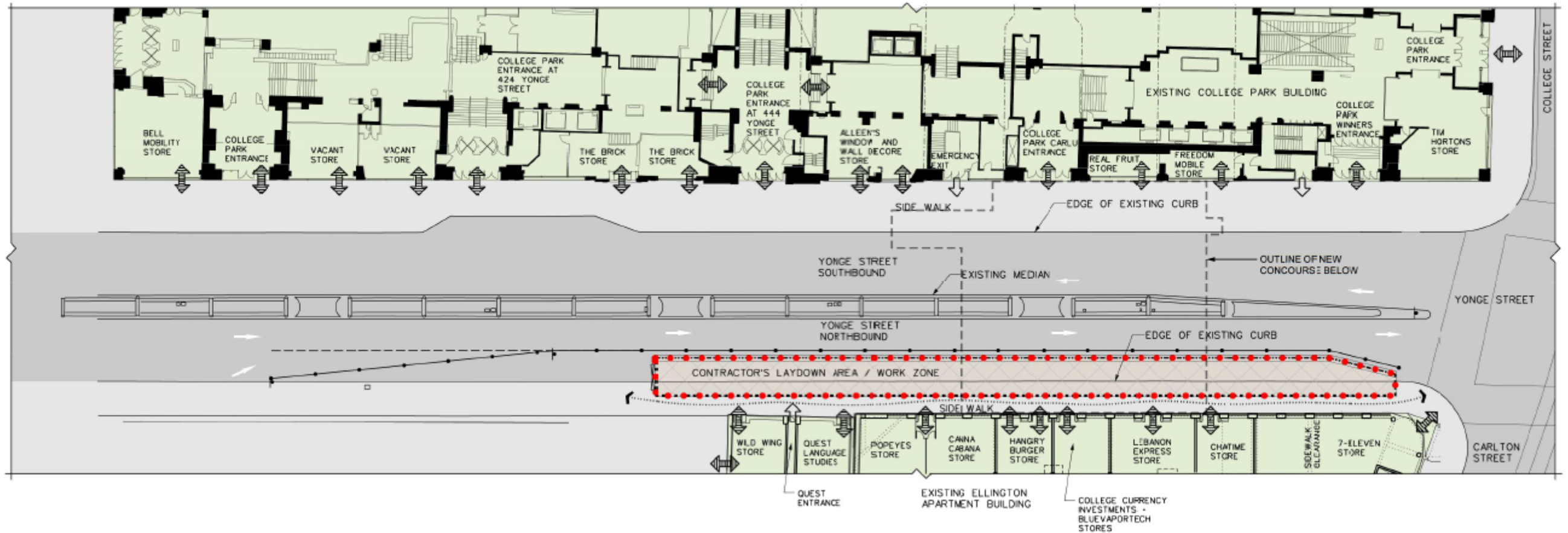

Preliminary Construction Staging – Stage 2

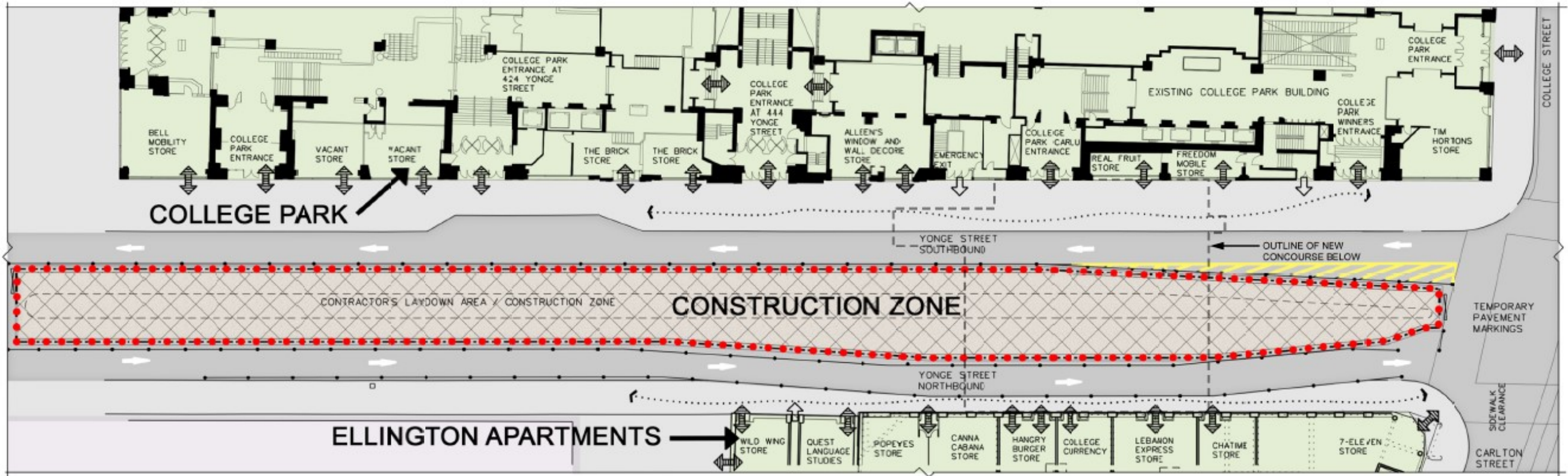

Preliminary Construction Staging – Stage 3

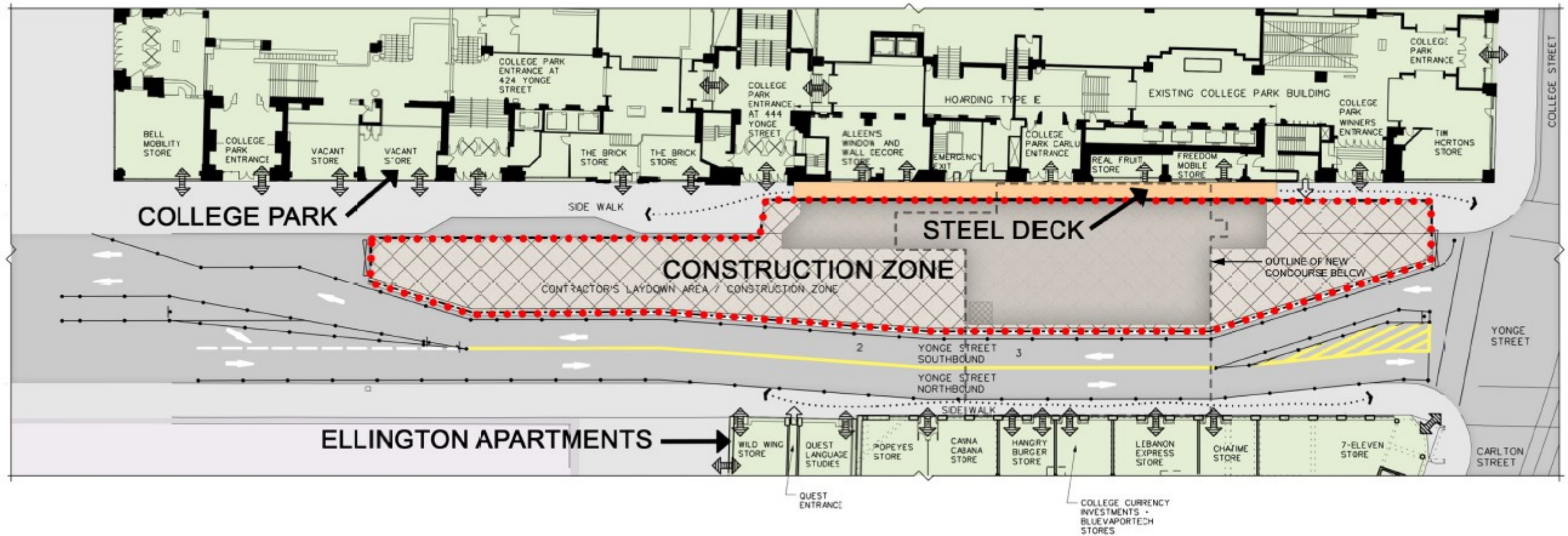

Preliminary Construction Staging – Stage 4

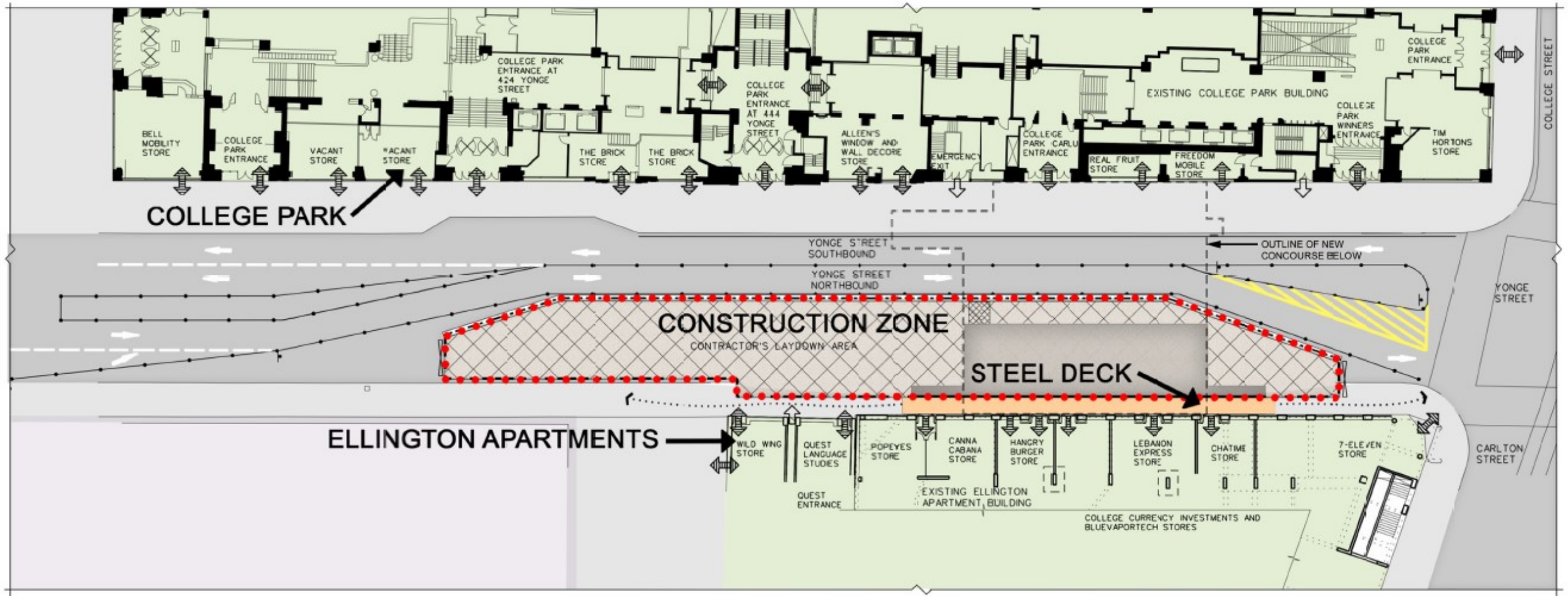

Preliminary Construction Staging – Completion

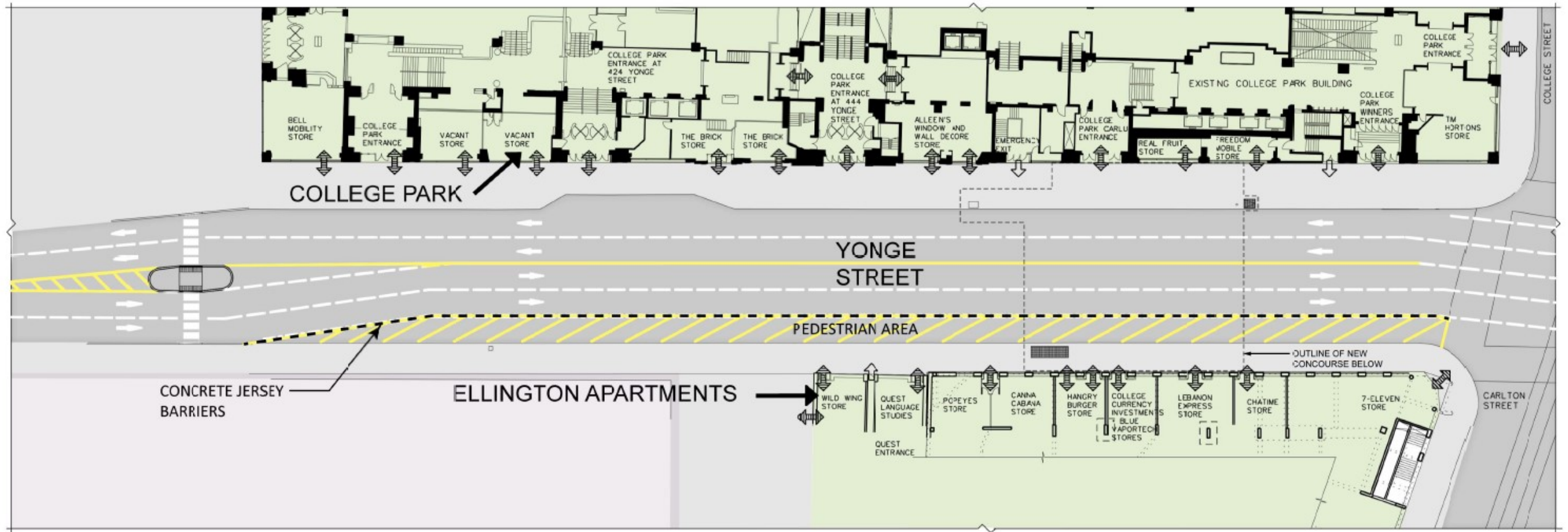

| Challenges

- Limited space at street level for staircase and elevators.
- Limited space *below* Yonge Street for construction due to existing utilities.



| Construction Planning

- Work to be completed in stages to reduce impact on community, pedestrians, cyclists and motorists.
- Subway service planned to run throughout.
- Temporary road decking installed to maintain transit, pedestrian access and traffic through Yonge/College intersection.
- One lane of traffic in each direction will be maintained.



| Access

- One lane in each direction on Yonge Street will be maintained during construction.
 - Available lanes on Yonge Street will shift to accommodate different phases of construction.
- Through-traffic, transit, and sidewalks on College Street will not be directly impacted by construction.
- Safe pedestrian access will be maintained with sidewalk detours as required. Diversions will be clearly marked.

| Construction Impacts & Work Hours

- As with all construction projects in the City; dust, noise and vibration is to be expected during periods of construction. The contractor will abide by City guidelines to keep disruption to a minimum.
- The majority of construction work will take place from 7 a.m. to 7 p.m.
- Some extensions outside of these hours may be required to facilitate deliveries and to accommodate the operation of local businesses.

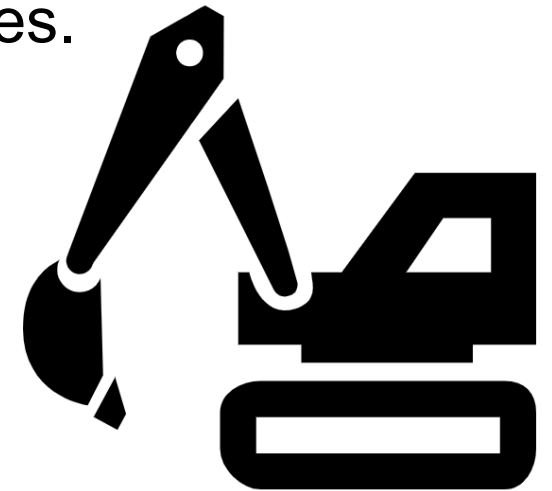

| Public Art and Station Features

- In order to protect the existing art (Hockey Knights in Canada by Charles Pachter), portions of the art may be temporarily removed, stored and replaced after construction.
- As part of TTC's Public Art Policy, we have commissioned the original artist for College Station, Charles Pachter, to expand on his existing artwork in the station.



| Contact

For updates on the project visit ttc.ca/projects [*Station Improvements*]

or contact:

Niki Angelis

Construction Liaison, TTC

Niki.Angelis@ttc.ca

(416) 981-1532